

# ST2 - STRIP 2 LAMPS

<b>Project</b>			
<b>Catalog #</b>			
<b>Volts</b>		<b>Lamp(s)</b>	
<b>Ballast Type</b>			
<b>Type</b>		<b>Date</b>	
<b>Approved by</b>			

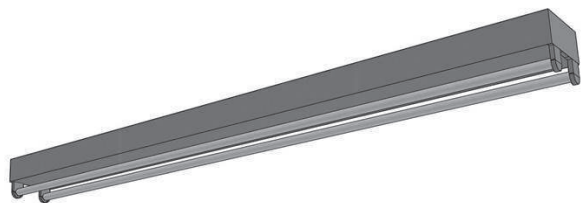

## General

Surface mount double-lamps commercial fixture for functional applications of general lighting.

Suitable for surface, pendant, and continuous row mounting.

## Housing & Finishing

Die-formed cold rolled steel finished in pre-painted high-gloss white. The body and the ends are riveted, increasing strength and rigidity.

Optional wire guard protects the fixtures from impact and breakage.

## Electrical

Available in electronic ballasts only.

Available voltages: 120V, 347V and UNV (120-277).

Note: 15" - 120V only.

## Approval

CSA and CSA-US certified.

## Ordering Information

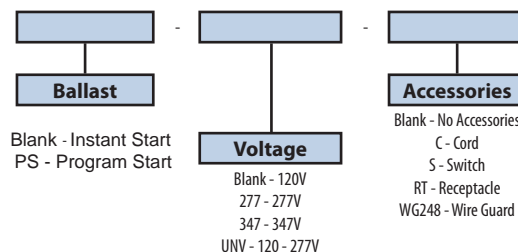
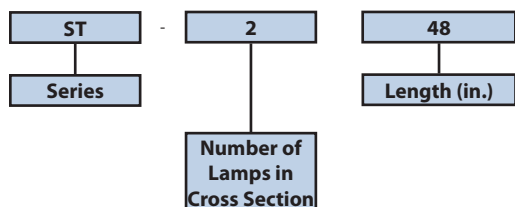

**NOTE:** Some items may no longer be available. Check with factory before quoting/ordering

## Product Availability \* Minimum qtys.apply for "N" narrow series

Item	Dimensions (L x W x D)	Lamps/ Cross Section	Lamps/ Fixture	Lamp Watt T8
ST 224	24" x 4 1/2" x 2"	2	2	17
ST 236	36" x 4 1/2" x 2"	2	2	25
ST 248	48" x 4 1/2" x 2"	2	2	32
ST 260	60" x 4 1/2" x 2"	2	2	40
ST 296T	96" x 4 1/2" x 2"	2	4	32

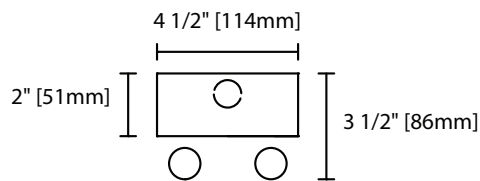

ST2 Cross Section View

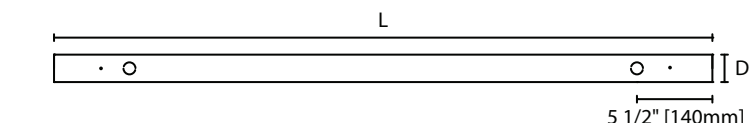

ST2 Side View

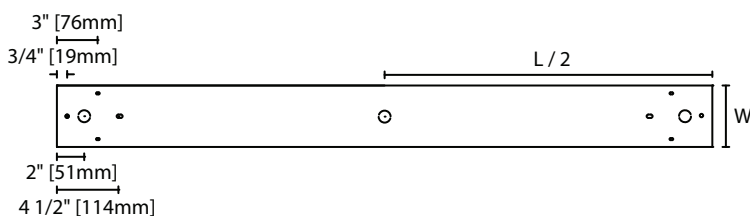

ST2 Base View

## LED TUBE DISCLAIMER

Pioneer fluorescent fixtures are designed and CSA listed *only* for the fluorescent lamps as indicated on the fixture label. Pioneer cannot guarantee proper operation of any other lamp types installed, including LED tubes. This will void the original factory warranty and Pioneer will not be responsible for any costs or damages incurred as a result. It is the sole responsibility of the LED tube supplier to confirm compatibility with our ballasts.

See our Terms and Conditions of Sale, paragraph 9 – Warranties and Remedies



PIONEER LIGHTING

300 Dwight Avenue, Toronto, Ontario M8V 2W7, CANADA  
T: 416-255-0405 F: 416-255-4002 [www.pioneerlighting.com](http://www.pioneerlighting.com)