



**Lightolier LyteCaster LED Accent Downlights** feature a 3.5" luminaire height that conserves plenum space without compromising the 60° physical and reflected cutoff. The modular and interchangeable light engine allows for an easy future upgrade. The accent downlight is damp location listed and comes in 3 standard finish options.

Project: \_\_\_\_\_  
 Location: \_\_\_\_\_  
 Cat.No: \_\_\_\_\_  
 Type: \_\_\_\_\_  
 Qty: \_\_\_\_\_  
 Notes: \_\_\_\_\_

Complete luminaire = Frame-in kit + Light engine + Trim Order each separately

### Frame

example: **L3AE1**

Series	Installations	Dimming	Voltage
<b>L3</b>	<input type="checkbox"/>	<input type="checkbox"/>	<input type="checkbox"/>
L3 LyteCaster 3" Accent	<b>A</b> AirSeal IC, New Construction, Screw <b>AN</b> AirSeal IC, New Construction, Nail <b>C</b> Remodeler Non-IC	<b>E</b> ELV/Triac	<b>1</b> 120V
	<b>N</b> New construction (Non-IC)	<b>Z10</b> 0-10V	<b>U</b> Universal (120-277V)

### Light engine

example: **L308930NF**

Series	Lumens	CRI/CCT	Beam
<b>L3</b>	<b>08</b>	<input type="checkbox"/>	<input type="checkbox"/>
L3 LyteCaster 3" Accent	08 800lm	<b>927</b> 90 CRI / 2700K <b>930</b> 90 CRI / 3000K <b>935</b> 90 CRI / 3500K <b>940</b> 90 CRI / 4000K	<b>S</b> Spot, 17° <b>NF</b> Narrow flood, 22° <b>F</b> Flood, 30°
		<b>9CW30</b> 90 CRI / 3000K Crisp White <b>9PW30</b> 90 CRI / 3000K Premium White <b>9PC30</b> 90 CRI / 3000K Premium Color	

### Round trim

example: **L3RDD**

Series	Shape	Style	Finish	Flange
<b>L3</b>	<b>R</b>	<input type="checkbox"/>	<input type="checkbox"/>	<input type="checkbox"/>
L3 LyteCaster 3" Accent	R Round	<b>D</b> Downlight	<b>C</b> Chrome cone <b>D</b> Diffuse cone <b>W</b> White cone	<b>blank</b> White
		<b>B</b> Baffle downlight	<b>W</b> White baffle	<b>blank</b> White

### Accessories

example: **L3AHW**

Series	Type	Beam	Finish
<b>L3</b>	<input type="checkbox"/>	<input type="checkbox"/>	<input type="checkbox"/>
L3 LyteCaster 3" Accent	<b>AH</b> Accessory holder	—	<b>W</b> White <b>B</b> Black
	<b>LS</b> Linear lens spread film (accessory holder required) <b>SD</b> 5° soft diffusion film (accessory holder required)		—
	<b>RP</b> Replacement Optic	<b>S</b> Spot, 17° <b>NF</b> Narrow flood, 22° <b>F</b> Flood, 30°	—

# L3RD LyteCaster LED 3" Accent

## Round Downlight

### Assembled configuration:

1. Frame Galvanized steel construction with internal access door for inspection of junction box.
2. LED Module Extruded Aluminum clear anodized finish heat sink with thermal interface material efficiently transfers heat away from LED. Includes strain relieved low voltage whip with snap interconnector for quick, tool-less assembly of power connection. Tool-less assembly to trim.
3. Accessory Film (Optional) Available film accessories: 0.010 thick Linear spread film has notch to assist with beam orientation Holder required; only one film allowed per installation.
4. Accessory Holder (Optional) painted steel. Accessory holder snaps onto LED Module. Can be installed before or after trim installation.
5. Mounting springs stainless steel mounting springs min 0.013" thick provide a universal mounting solution between the different frame offerings
6. Downlight Reflector: Aluminum Reflector Cone.
7. Step Baffle: Molded polymeric material.
8. Die Cast Aluminum Trim Flange.

**Note:** LED module allows for field replaceable optics.  
Order separately.

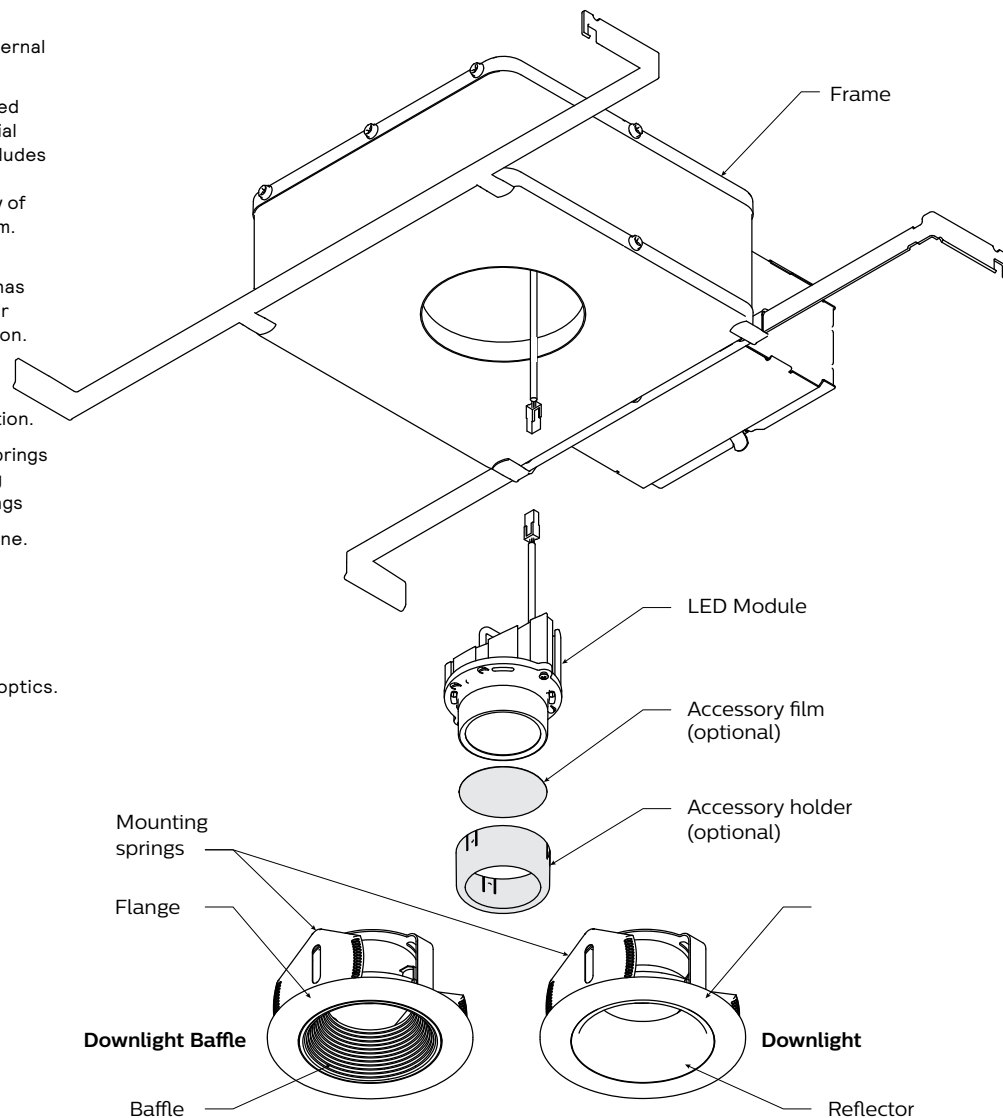

# L3RD LyteCaster LED 3" Accent Round Downlight

L3AE1 & L3ANE1 new construction in IC AirSeal frame-in kits

Bottom view

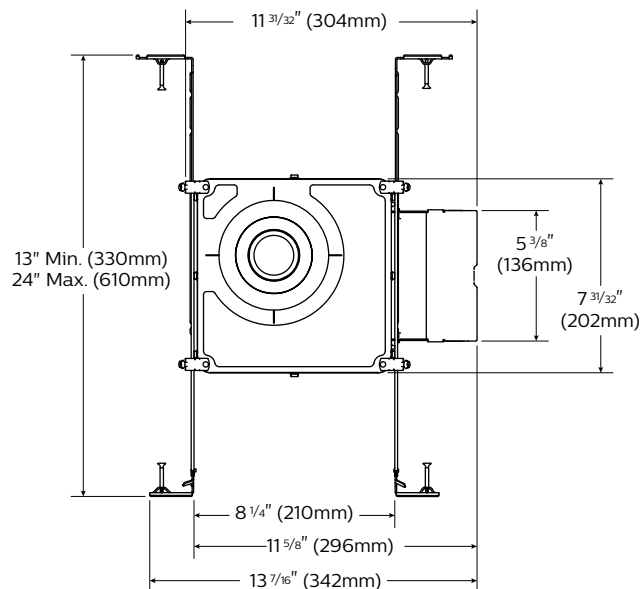

Side view

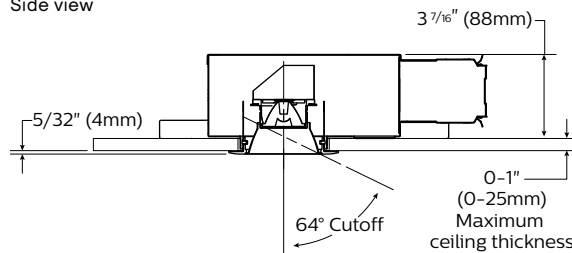

Round trim

Side view

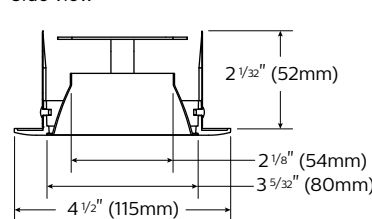

Light engine

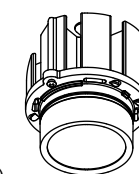

## Features

- Housing:** #23 ga. (.026") thick Galvanized steel. cULus listed for direct contact with thermal insulation (IC rated). AirSeal housing minimizes air leakage to less than 2 CFM at 1.57PSF (or 75PA), which complies with Title 24, the International Energy Conservation Code, and Washington State Energy Code (Section 502.4). This helps reduce heat loss and condensation in ceiling. Internal access door for inspection of junction box.
- Lower frame and top cover:** #23 ga. (.026") thick Galvanized steel. Accommodates ceilings up to 1" (25.4 mm) thick. Bottom cover provided with a 0.5" (6.2mm) lip and 4 embossed indicator lines to simplify alignment during installation. Housing can be locked into position on the mounting bars with locking screws.
- Junction box:** 2 1/2" (64mm) x 5 3/8" (137mm) x 2" (51mm) #21 ga. (.032") thick galvanized steel, cULus listed 90 degrees C rated supply conductors. Rated for branch circuit wiring supplying connected luminaires (daisy chaining).
- Mounting bars:** #16 ga. (.059") thick galvanized steel. Bars pivot for easy attachment and wire in from below the ceiling line. Bars can extend to accommodate 16" (406mm) to 24" (610mm) O.C. joist spacing. Bars can accommodate 12" (305mm) O.C. joist spacing after slight field modification (see instruction sheet). Features integral self-tapping screw phillips/square drive for attachment to wood or metal construction. Also available with integral nails (N). Attaches to T-bar ceilings without accessories. Bars installed on shortest dimension of frame can be easily rotated 90° from original position.
- Electronic dimming driver:** Class 2 electronic LED Driver, with less than 1 second start up, RoHS compliant, suitable for damp locations. 120v 50/06Hz >0.9 power factor. Sound rating Class "A" (<24dB). Complies with FCC, CFR title 47 part 15 Class B for EMI/RFI. Dimmable with standard electronic low voltage (ELV) & Triac dimmers. Dims to less than or equal to 10% of relative high output. 5 year limited warranty.
- Ceiling cutout:** 3 3/4" diameter.
- Optics:**
  - Standard:** 3SDCM fixture-to-fixture color match.
  - Crisp White (CW30):** Available in 90CRI / 3000K only, our 90CRI CrispWhite technology combines the warm, saturated colors of high CRI with crisp and vibrant whites. The small form factor and high quality of light make this an impactful option for retail display areas.
  - Premium White (PW30):** Available in 90CRI/3000K only, the new benchmark in retail fashion, delivering stronger, brighter whites via the best technology in the market, but with minimal compromise on energy savings.
  - Premium Color (PC30):** Available in 90CRI/3000K only, provides vivid and robust colors that pop while maintaining a strong ambient white and bold black balance in any space. This LED technology is sure to add positive energy to varying application needs.

## Electrical

Input voltage: 120V  
Input frequency: 50/60Hz  
Input current: 0.25A  
Input Power: 12W  
Power factor: >0.9

## Labels

cULus type IC listed suitable for damp locations.

AirSeal - Rated for installation in insulated ceilings. Air-tite rated per ASTM E283.

Compliant to California Title 24 JA8, and certified to the Title 20 appliance database. E1 frames only.

Energy Star qualified configurations available.

## Warranty



5 year limited warranty  
Visit [Signify.com/warranties](https://www.signify.com/warranties) for more information on Signify's standard 5-year limited warranty on complete luminaire systems.

# L3RD LyteCaster LED 3" Accent Round Downlight

## L3NZ10V New construction Non-IC 0-10V frame-in kit

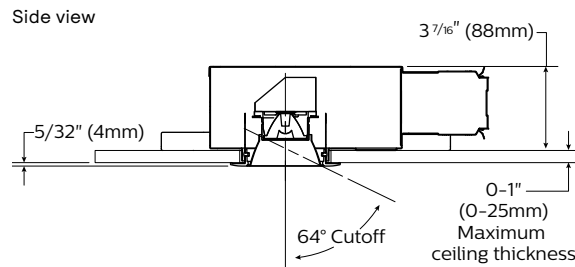
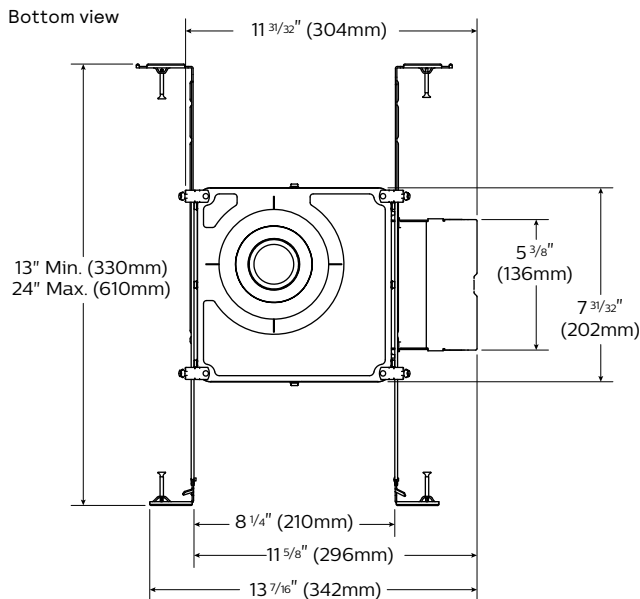

### Round trim

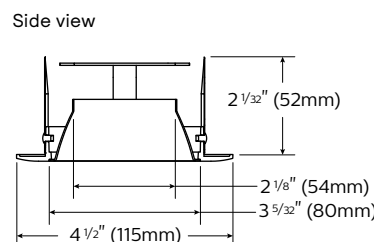

### Light engine

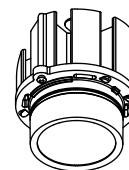

## Features

- Non-IC housing:** #23 ga. (.026") thick Galvanized steel. cULus listed for damp locations. AirSeal housing minimizes air leakage to less than 2CFM at 1.57 PSF (or 75PA), complies with Title 24, International Energy Conservation Code, and Washington State Energy Code (section 502.4) Frame provided with internal access door for inspection of junction box.
- Lower frame and top cover:** #23 ga. (.026") thick Galvanized steel. Accommodates ceilings up to 1" (25.4 mm) thick. Bottom cover provided with a .5" (6.2mm) lip and 4 embossed indicator lines to simplify alignment during installation. Housing can be locked into position on the mounting bars with locking screws.3. **Junction box:** 2 1/2" (64mm) x 5 3/8" (137mm) x 2" (51mm) #21 ga. (.032") thick galvanized steel, cULus listed 90 degrees C rated supply conductors. Rated for branch circuit wiring supplying connected luminaires (daisy chaining).
- Mounting bars:** #16 ga. (.059") thick galvanized steel. Bars pivot for easy attachment and wire in from below the ceiling line. Bars can extend to accommodate 16" (406mm) to 24" (610mm) O.C. joist spacing. Bars can accommodate 12" (305mm) O.C. joist spacing after slight field modification. (see instruction sheet) Features integral self-tapping screw Phillips/square drive screws for attachment to wood or metal construction. Attaches to T-bar ceilings without accessories. Bars installed on shortest dimension of frame can be easily rotated 90° from original position.
- Electronic dimming driver:** Class 2 electronic LED driver, RoHS compliant, suitable for damp location. 120/277v 50/60Hz >.9 power factor. MTP (module thermal protection) current cutback up to 10% to prevent overheating. Sound rating Class "A" (<24dB). Complies with FCC, CFR title 47 part 15 Class A for EMI/RFI. Dimming Protocol (0-10v). Dims to less than or equal to 10% of relative high output.
- Ceiling cutout:** 3 3/4" diameter.
- Optics:**
  - Standard: 3SDCM fixture-to-fixture color match.
  - Crisp White (CW30):** Available in 90CRI / 3000K only, our 90CRI CrispWhite technology combines the warm, saturated colors of high CRI with crisp and vibrant whites. The small form factor and high quality of light make this an impactful option for retail display areas.
  - Premium White (PW30):** Available in 90CRI/3000K only, the new benchmark in retail fashion, delivering stronger, brighter whites via the best technology in the market, but with minimal compromise on energy savings.
  - Premium Color (PC30):** Available in 90CRI/3000K only, provides vivid and robust colors that pop while maintaining a strong ambient white and bold black balance in any space. This LED technology is sure to add positive energy to varying application needs.

## Electrical

Input voltage: 120/277V  
Input frequency: 50/60Hz  
Input current: 0.14A/0.06A  
Input Power: 16.4W  
Power factor: >0.9

## Labels

cULus listed suitable for damp locations.  
AirSeal - Rated for installation in insulated ceilings. Air-tite rated per ASTM E283.  
Energy Star qualified configurations available.

## Warranty



5 year limited warranty  
Visit [Signify.com/warranties](https://www.signify.com/warranties) for more information on Signify's standard 5-year limited warranty on complete luminaire systems.

# L3RD LyteCaster LED 3" Accent

## Round Downlight

### L3CE1 Non-IC Remodeler kit

Bottom view

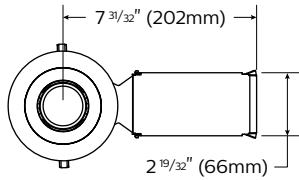

Side view

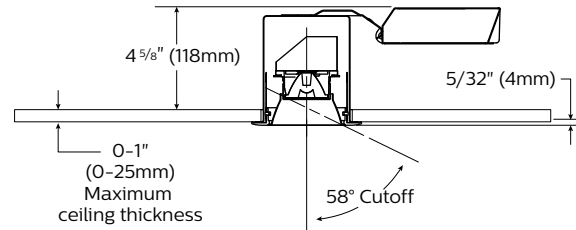

Round trim

Side view

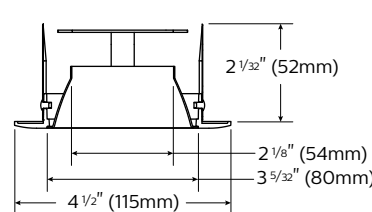

Light engine

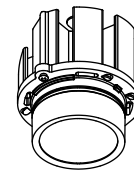

### Features

1. **Non-IC housing:** #25 ga. (.025") thick Galvanized steel. Provided with 2 plates steel retaining springs that can accommodate ceiling thickness up to 1" (25.4mm) thick. Philips screw driver required to tighten springs that secure housing to ceiling.
2. **Junction box:** #22 ga. (.034") thick Galvanized steel. cULus ,suitable for damp locations. Junction box assembly swivels for tight plenum spaces. Snap off cover permits wiring access. 0
3. **Electronic dimming driver** (same as new construction): Class 2 electronic LED Driver, with less than 1 second start up, RoHS compliant, suitable for damp locations. 120v 50/60Hz >.9 power factor. Sound rating Class "A" (<24dB). Complies with FCC,CFR title 47 part 15 Class B for EMI/RFI. Dimmable with standard electronic low voltage (ELV) & Triac dimmers. Dims to less than or equal to 10% of relative high output. 5 year limited warranty.
4. **Trim compatibility:** Not compatible with adjustable trims except for L3RG series Gimbals.
5. **Ceiling cutout** 3 3/4" diameter.

### 6. Optics:

- Standard: 3SDCM fixture-to-fixture color match.
- **Crisp White (CW30):** Available in 90CRI / 3000K only, our 90CRI CrispWhite technology combines the warm, saturated colors of high CRI with crisp and vibrant whites. The small form factor and high quality of light make this an impactful option for retail display areas.
- **Premium White (PW30):** Available in 90CRI/3000K only, the new benchmark in retail fashion, delivering stronger, brighter whites via the best technology in the market, but with minimal compromise on energy savings.
- **Premium Color (PC30):** Available in 90CRI/3000K only, provides vivid and robust colors that pop while maintaining a strong ambient white and bold black balance in any space. This LED technology is sure to add positive energy to varying application needs.

### Electrical

Input voltage: 120V  
Input frequency: 50/60Hz  
Input current: 0.25A  
Input Power: 12W  
Power factor: >0.9

### Labels

cULus type IC listed suitable for damp location.

AirSeal - Rated for installation in insulated ceilings. Air-tite rated per ASTM E283.

Energy Star qualified configurations available.

### Warranty



5 year limited warranty  
Visit [Signify.com/warranties](https://www.signify.com/warranties)  
for more information on Signify's  
standard 5-year limited warranty  
on complete luminaire systems.

# L3RD LyteCaster LED 3" Accent

## Round Downlight



### AccuRender Technology (CRI 90+)

The right light brings colors to life. Our new AccuRender technology helps ensure colors are rendered more accurately and consistently, while doing so as efficiently as CRI 80 products.



**Standard CRI 80**

Good color rendering  
and high efficacy



**Standard CRI 90**

Better color rendering  
and low efficacy



**AccuRender**

Best color rendering,  
color preference and high efficacy

#### Enjoy design flexibility

Full range of products and options:

- Available soon in across Lightolier portfolio for application flexibility
- Multiple color temperatures (CCTs) and lumen packages offered

#### Promote savings

High efficacy, with no penalty:

- Energy efficacy compares well to conventional 80 CRI
- Up to 25% more energy savings vs competitor 90 CRI<sup>1</sup>
- Helps meet Title 24 requirements

#### Show your true colors

High color rendering:

- True to life colors to help energize your environment and render better flesh tones critical for healthcare hospitality and retail applications.
- R<sub>a</sub> up to 94 CRI
- R<sub>g</sub> up to 67 CRI
- G<sub>s</sub> up to 99 CRI
- C<sub>9</sub> up to 94 CRI
- R<sub>f</sub> up to 92 TM-30
- R<sub>f,hi</sub> up to 91 TM-30
- R<sub>g</sub> up to 100 TM-30
- R<sub>cb,hi</sub> up to -5% TM-30

#### Achieve color balance

Best in class color consistency:

- Promote aesthetic harmony in your space with  $\leq 2$  SDCM

#### Electrical Specifications

Frame-in kit	Input Volts	Input Frequency	Input Current	LED Drive Current	Input Power	LED Power	THD Factor @ Max Load	Power Factor @ Max Load
L3AE1	120V	50/60Hz	0.075A	0.22A	9.0W	7.4W	<15%	>0.9
L3ANE1	120V	50/60Hz	0.075A	0.22A	9.0W	7.4W	<15%	>0.9
L3CE1	120V	50/60Hz	0.075A	0.22A	9.0W	7.4W	<15%	>0.9
L3NZ10U	120V	50/60Hz	0.073A	0.22A	8.8W	7.4W	<10%	>0.9
	277V	50/60Hz	0.033A	0.22A	9.0W	7.4W	<10%	>0.9
L3CZ10U	120V	50/60Hz	0.081A	0.22A	9.7W	7.4W	<10%	>0.9
	277V	50/60Hz	0.035A	0.22A	9.7W	7.4W	<10%	>0.9

#### Dimming Compatibility

Philips Sunrise: **SR1200ZTUNV**

Leviton Illumatech: **IPX06**

Leviton Decora: **6615-P, 6633-P**

Lutron Diva: **DVLEV-303P**

Lutron Skylark: **SLEV-300P**

Lutron Maestro: **MAELV-600, MAW-600**

#### Electronic dimming driver:

Class 2 electronic LED Driver, with less than 1 second start up, RoHS compliant, suitable for damp locations. 120v 50/60Hz >.9 power factor. Sound rating Class "A" (<24dB). Complies with FCC, CFR title 47 part 15 Class B for EMI/RFI. Dimmable with standard electronic low voltage (ELV) & Triac dimmers. Dims to less than or equal to 10% of relative high output. 5 year limited warranty.

# L3RD LyteCaster LED 3" Accent

## Round Downlight



### Photometry (1000lm)

Download  
Round 3"  
IES Files



Download  
REVIT files  
& BIM files



Beam Spread	Color Temp (CCT)	Flux (lm)	Power (W)	Efficacy (lm/W)	CRI	R9	Beam Angle	Field Angle	Spacing Criterion	UGR
<b>Spot (S)</b> 	2700K	804	8.9	90.6	92	54	17°	41°	0.309	4.6
	3000K	840	8.9	94.7	92	54	17°	41°	0.309	4.8
	3500K	840	8.9	94.4	92	54	17°	41°	0.309	5.0
	4000K	899	8.9	101.4	92	54	17°	41°	0.309	5.0
	Crisp White	640	8.9	72.2	92	54	17°	41°	0.309	3.8
	Premium White	852	8.9	96.1	92	54	17°	41°	0.309	4.8
	Premium Color	777	8.9	87.6	92	54	17°	41°	0.309	4.6
<b>Narrow Flood (NF)</b> 	2700K	833	8.9	93.6	92	53	22°	44°	0.387	4.2
	3000K	871	8.9	97.8	92	53	22°	44°	0.387	4.4
	3500K	871	8.9	97.8	92	53	22°	44°	0.387	4.5
	4000K	932	8.9	104.7	92	53	22°	44°	0.387	4.6
	Crisp White	664	8.9	74.6	92	53	22°	44°	0.387	3.4
	Premium White	883	8.9	99.2	92	53	22°	44°	0.387	4.4
	Premium Color	805	8.9	90.5	92	53	22°	44°	0.387	4.1
<b>Flood (F)</b> 	2700K	868	8.9	97.7	92	53	34°	64°	0.571	5.4
	3000K	907	8.9	102.0	92	53	34°	64°	0.571	5.6
	3500K	907	8.9	101.9	92	53	34°	64°	0.571	5.7
	4000K	971	8.9	109.2	92	53	34°	64°	0.571	5.8
	Crisp White	691	8.9	77.8	92	53	34°	64°	0.571	4.8
	Premium White	920	8.9	103.5	92	53	34°	64°	0.571	5.6
	Premium Color	839	8.9	94.4	92	53	34°	64°	0.571	5.4

1. Luminaire photometry has been conducted in accordance with IES LM-79-08. IES files can be downloaded by clicking the links in the table above, or online at [lightolier.com](http://lightolier.com).
2. Crisp White, Premium White and Premium Color - 3000K results.
3. Color Rendering Index (CRI Ra ) and Strong Red (R<sub>9</sub>) are calculated in accordance with CIE 013.3-1995.



# L3RD LyteCaster LED 3" Accent

## Round Downlight

### Downlight, Spot beam, 800lm engine, 95lm/W at 9W

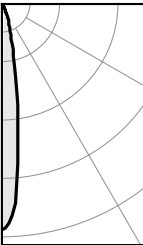
<div>Candela Curve</div> 	Frame: L3NZ10U	Angle	Mean CP	Lms	Zonal lumens & percentages			Single unit data		
	Engine: L308935S	0	5302					Height to	Initial center beam	Beam
	Trim: L3RDD	5	4256					lighted plane	foot-candles	dia. (ft)
		10	2061	328	Zone	Lumens	%Luminaire			
	Output Lms: 841lms	15	990		0-30	761	90.5%			
	Input Watts: 8.9 W	20	550	288	0-40	817	97.1%			
	CCT: 3500K	25	307		0-60	837	99.5%			
	CRI: 90min	30	167	145	0-90	841	100.0%			
	Beam Angle: 17°	35	84							
	Spacing Crit.: 0.33	40	37	56						
		45	19							
	Efficacy: 94.5lm/w	50	9	15						
	Report: L308935S-L3RDD.ies	55	6							
		60	4	5						
		65	3							
		70	2	3						
	75	1								
	80	1	1							
	85	0								
	90	0	0							

\* Beam diameter is where foot-candles drop to 50% of maximum.

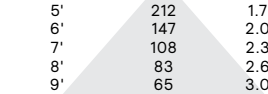

\*Beam diameter is where foot-candles drop to 50% of maximum.

### Downlight, Narrow Flood beam, 800lm engine, 95lm/W at 9W

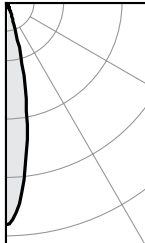
<div>Candela Curve</div> 	Frame: L3NZ10U	Angle	Mean CP	Lms	Zonal lumens & percentages			Single unit data			
	Engine: L308935NF	0	4281					Height to	Initial center beam	Beam	
	Trim: L3RDD	5	3668					lighted plane	foot-candles	dia. (ft)	
	Output Lms: 872lms	10	2405	309	Zone	Lumens	%Luminaire				
	Input Watts: 8.9W	15	1246		0-30	789	90.5%				
	CCT: 3500K	20	563	349	0-40	841	96.4%				
	CRI: 90min	25	266		0-60	869	99.7%				
	Beam Angle: 22°	30	142	131	0-90	872	100.0%				
	Spacing Crit.: 0.38	35	80								
		40	43	52							
		45	27								
		50	15	21							
		55	7								
		60	5	7							
		65	2								
		70	1	3							
	75	1									
	80	0	1								
	85	0									
	90	0	0								
	Efficacy: 98.0lm/w								*Beam diameter is where foot-candles drop to 50% of maximum.		
	Report: L308935NF-L3RDD.ies										

\*Beam diameter is where foot-candles drop to 50% of maximum.

### Downlight, Flood beam, 800lm engine, 95lm/W at 9W

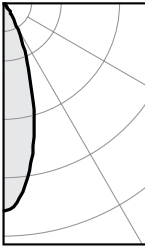
<div>Candela Curve</div> 	Frame: L3NZ10U	Angle	Mean CP	Lms	Zonal lumens & percentages			Single unit data		
	Engine: L308935F	0	2223					Height to	Initial center beam	Beam
	Trim: L3RDD	5	2088					lighted plane	foot-candles	dia. (ft)
	Output Lms: 907lms	10	1735	188	Zone	Lumens	%Luminaire			
	Input Watts: 8.9W	15	1279		0-30	776	85.6%			
	CCT: 3500K	20	845	350	0-40	872	96.1%			
	CRI: 90min	25	512		0-60	902	99.4%			
	Beam Angle: 34°	30	291	238	0-90	907	100.0%			
	Spacing Crit.: 0.56	35	147							
		40	62	96						
		45	27							
		50	14	23						
		55	7							
		60	5	7						
	Efficacy: 98.0lm/w	65	3							
Report: L308935F-L3RDD.ies	70	2	3							
	75	1								
	80	1	1							
	85	0								
	90	0	0							
</										

\*Beam diameter is where foot-candles drop to 50% of maximum.

1. Wattage: controlled to within 5%.
2. Correlated Color Temperature within specs as defined in ANSI/NEMA-ANSI C78.377-2008: Specifications for the Chromaticity of Solid State Lighting Products.
3. Tested using absolute photometry as specified in LM79: IESNA Approved Method for the Electrical and Photometric Measurements of Solid-State Lighting Products.



© 2023 Signify Holding. All rights reserved. The information provided herein is subject to change, without notice. Signify does not give any representation or warranty as to the accuracy or completeness of the information included herein and shall not be liable for any action in reliance thereon. The information presented in this document is not intended as any commercial offer and does not form part of any quotation or contract, unless otherwise agreed by Signify.

Signify North America Corporation  
 400 Crossing Blvd, Suite 600  
 Bridgewater, NJ 08807  
 Telephone: 800-555-0050

Signify Canada Ltd.  
 281 Hillmount Road,  
 Markham, ON, Canada L6C 2S3  
 Telephone: 800-668-9008

All trademarks are owned by Signify Holding or their respective owners.