

L1EPH

ECONO LED HIGH BAY LUMINAIRE

Our new series of LED economical High Bays is an energy efficient solution that is ideal for use in applications such as warehouses, sports arenas, and other large, high ceiling indoor applications.

FEATURES AND SPECIFICATIONS

• Construction

Housing

White powder painted 22 gauge steel housing. Well ventilated driver compartment for optimal thermal management.

Installation and hardware

V Hooks for dual point chain or cable hanging (standard). Pendant or surface mount optional.

Lens

Frosted acrylic lens over LEDs provides a diffused distribution of light.

Ambient temperature

-30°C to 50°C.

• Electrical

- Power Factor (PF) - >0.9
- Total Harmonic distortion (THD) - <20%
- 132lm/W
- 0-10V dimming standard
- 80+ CRI, 4000K and 5000K color temperature
- 6ft cable is standard
- 120-277V and 347V

• Compliances

- Meets requirements of ICES-005 Issue Edition 4 for class A products
- DLC standard and premium on certain configurations for indoor luminaires, for primary use in high bay applications
- cULus Certified

MOUNTING OPTIONS & ACCESSORIES



SURFACE MOUNT



PENDANT MOUNT WITH HOOKS (V-HOOKS STANDARD)



CONDUIT MOUNT



WITH WIREGUARD

Project: _____
 Type: _____
 Catalogue #: _____
 Drawn by: _____
 Date: _____

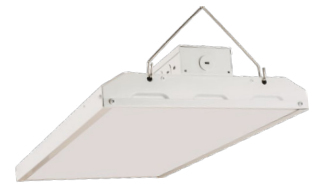

24"

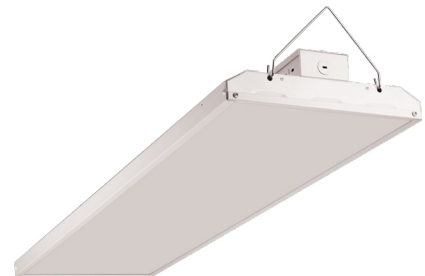

48"



Not all products are qualified on the DLC QPL. To view our DLC qualified products, please consult the DLC Qualified Products List at www.designlights.org/search.

OVERVIEW

| | |
|--------------------|-------------------------------|
| Light source | LED |
| Wattage | 90W - 320W |
| Lumens | 11,700lm - 38,558lm |
| lm/W | 118lm/W - 132lm/W |
| Colour temperature | 4000K and 5000K |
| CRI | 80+ |
| Weight | 24": 13.45 lbs 48": 27 lbs |

QUICK SHIP ORDERING GUIDE ⌚*

| Dimensions | Part number | Wattage | Lumens | Voltage | Colour temperature | lm/W | PF | CRI | THD |
|------------|--------------------|---------|---------|----------|--------------------|---------|------|-----|-----|
| 24" | L1EPH-24LS2-W/40K | 90W | 11,700L | 120-277V | 4000K | 130lm/W | 0.9 | 80 | 10 |
| 24" | L1EPH-24LS2-W/50K | 90W | 11,790L | 120-277V | 5000K | 131lm/W | 0.9 | 80 | 10 |
| 24" | L1EPH-24LS2-H/40K | 90W | 11,700L | 347V | 4000K | 130lm/W | 0.9 | 80 | 10 |
| 24" | L1EPH-24LS2-H/50K | 90W | 11,790L | 347V | 5000K | 131lm/W | 0.9 | 80 | 10 |
| 24" | L1EPH-24LS3-W/40K | 135W | 17,550L | 120-277V | 4000K | 130lm/W | 0.9 | 80 | 10 |
| 24" | L1EPH-24LS3-W/50K | 135W | 17,685L | 120-277V | 5000K | 131lm/W | 0.9 | 80 | 10 |
| 24" | L1EPH-24LS3-H/40K | 135W | 17,550L | 347V | 4000K | 130lm/W | 0.9 | 80 | 10 |
| 24" | L1EPH-24LS3-H/50K | 135W | 17,685L | 347V | 5000K | 131lm/W | 0.9 | 80 | 10 |
| 48" | L1EPH-48LS1-H/40K | 220W | 25,162L | 347V | 4000K | 118lm/W | 0.97 | 80 | 8.6 |
| 48" | L1EPH-48LS1A-W/40K | 178W | 23,140L | 120-277V | 4000K | 130lm/W | 0.9 | 80 | 10 |
| 48" | L1EPH-48LS1A-W/50K | 178W | 23,318L | 120-277V | 5000K | 131lm/W | 0.9 | 80 | 10 |
| 48" | L1EPH-48LS1A-H/50K | 178W | 23,318L | 347V | 5000K | 131lm/W | 0.99 | 80 | 10 |
| 48" | L1EPH-48LS2-W/40K | 320W | 38,558L | 120-277V | 4000K | 120lm/W | 0.97 | 80 | 8.6 |
| 48" | L1EPH-48LS2-H/40K | 265W | 34,715L | 347V | 4000K | 131lm/W | 0.9 | 80 | 10 |
| 48" | L1EPH-48LS2A-W/50K | 265W | 34,715L | 120-277V | 5000K | 131lm/W | 0.9 | 80 | 10 |
| 48" | L1EPH-48LS2A-H/50K | 265W | 34,980L | 347V | 5000K | 132lm/W | 0.99 | 80 | 10 |

* **QUICK SHIP:** Product availability is subject to change without notice. Please contact your Stanpro customer service representative to confirm inventory levels at time of order.

TM21 TABLE – L1EPH 24"

| | |
|---|----------|
| Time (t) at which to estimate lumen maintenance (hours) | 50,000 |
| Lumen maintenance at time (t) (%) | 86.90% |
| Calculated L70 (hours) | 120,000 |
| Reported L70 (hours) | > 36,000 |

TM21 TABLE – L1EPH 48"

| | |
|---|----------|
| Time (t) at which to estimate lumen maintenance (hours) | 50,000 |
| Lumen maintenance at time (t) (%) | 82.53% |
| Calculated L70 (hours) | 88,000 |
| Reported L70 (hours) | > 72,000 |

Comments

ACCESSORIES (order separately)

| | |
|--------------|--|
| BKT486 | Conduit mount kit 20 gauge bracket (1pc per fixture) |
| BKT584-4L | Surface mount bracket for 48LS1, 48LS1A and 24LS2 (set of 2) |
| BKT584-6L | Surface mount bracket for 48LS2, 48LS2A and 24LS3 (set of 2) |
| WGD063-4-KIT | Wireguard for 48LS1 and 48LS1A |
| WGD063-6-KIT | Wireguard for 48LS2 and 48LS2A |
| WGD904-4-KIT | Wireguard for 24LS2 |
| WGD904-6-KIT | Wireguard for 24LS3 |

DIMENSIONS

48"

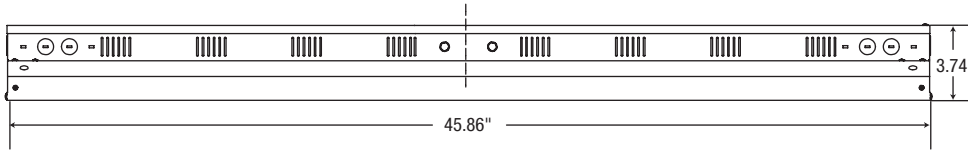

24"

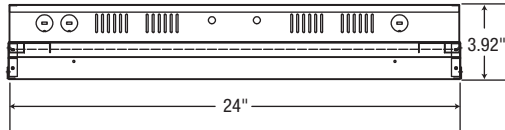

24" - LS2 & 48" - LS1A (120V-277V)
LS1 (347V)

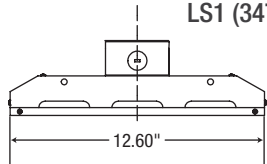

24" - LS3 & 48" - LS2/LS2A (120V-277V)
LS2 (347V)

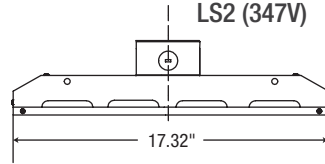

24" - LS2 & 48" - LS1A (347V)

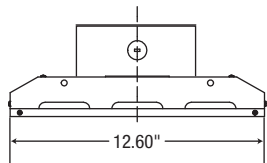

24" - LS3 & 48" - LS2A (347V)

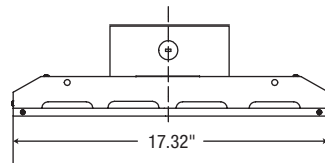

PHOTOMETRIC DATA

L1EPH-24LS2-(W-H)/40K • 11,231lm

Polar candela distribution

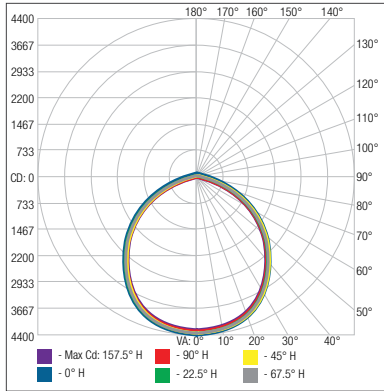

Zonal lumen summary

| Zone | Lumens | % Fixture |
|--------|----------|-----------|
| 0-30 | 3394.4 | 30.2% |
| 0-40 | 5521.4 | 49.2% |
| 0-60 | 9347.9 | 83.2% |
| 60-90 | 1883.1 | 16.8% |
| 70-100 | 719.1 | 6.4% |
| 90-120 | 0 | 0% |
| 0-90 | 11,231.0 | 100% |
| 90-180 | 0 | 0% |
| 0-180 | 11,231.0 | 100% |

Illuminance at a distance

| | Center beam fc | Beam width |
|-------|----------------|-------------|
| 1.7' | 1513 fc | 4.4' 4.2' |
| 3.3' | 401 fc | 8.5' 8.2' |
| 5.0' | 175 fc | 12.9' 12.4' |
| 6.7' | 97.4 fc | 17.3' 16.6' |
| 8.3' | 63.5 fc | 21.4' 20.6' |
| 10.0' | 43.7 fc | 25.7' 24.8' |

■ Vert. spread: 104.3°
■ Horiz. spread: 102.2°

L1EPH-24LS2-(W-H)/50K • 11,788.9lm

Polar candela distribution

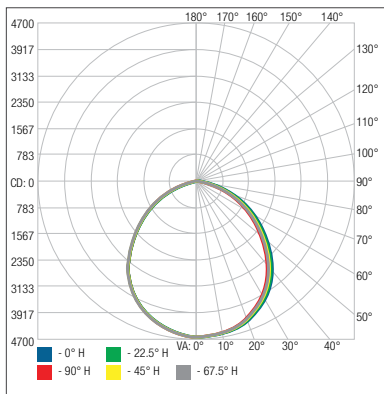

Zonal lumen summary

| Zone | Lumens | % Fixture |
|--------|----------|-----------|
| 0-30 | 3564.1 | 30.2% |
| 0-40 | 5797.5 | 49.2% |
| 0-60 | 9810.9 | 83.2% |
| 60-90 | 1978.0 | 16.8% |
| 70-100 | 758.7 | 6.4% |
| 90-120 | 0 | 0% |
| 0-90 | 11,788.9 | 100% |
| 90-180 | 0 | 0% |
| 0-180 | 11,788.9 | 100% |

Illuminance at a distance

| | Center beam fc | Beam width |
|-------|----------------|-------------|
| 1.7' | 1589 fc | 4.4' 4.2' |
| 3.3' | 422 fc | 8.5' 8.2' |
| 5.0' | 184 fc | 12.9' 12.4' |
| 6.7' | 102 fc | 17.2' 16.6' |
| 8.3' | 66.7 fc | 21.4' 20.5' |
| 10.0' | 45.9 fc | 25.7' 24.4' |

■ Vert. spread: 104.3°
■ Horiz. spread: 102.1°

L1EPH-24LS3-(W-H)/40K • 17,208.8lm

Polar candela distribution

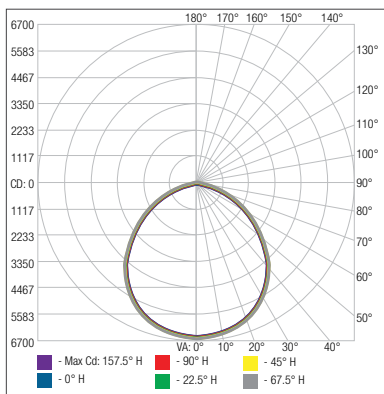

Zonal lumen summary

| Zone | Lumens | % Fixture |
|--------|----------|-----------|
| 0-30 | 5165.0 | 30% |
| 0-40 | 8413.4 | 48.9% |
| 0-60 | 14,288.4 | 83% |
| 60-90 | 2920.3 | 17% |
| 70-100 | 1124.5 | 6.5% |
| 90-120 | 0 | 0% |
| 0-90 | 17,208.8 | 100% |
| 90-180 | 0 | 0% |
| 0-180 | 17,208.8 | 100% |

Illuminance at a distance

| | Center beam fc | Beam width |
|-------|----------------|-------------|
| 1.7' | 2301 fc | 4.4' 4.3' |
| 3.3' | 611 fc | 8.5' 8.3' |
| 5.0' | 266 fc | 13.0' 12.6' |
| 6.7' | 148 fc | 17.4' 16.9' |
| 8.3' | 96.5 fc | 21.5' 21.0' |
| 10.0' | 66.5 fc | 25.9' 25.3' |

■ Vert. spread: 104.7°
■ Horiz. spread: 103.3°

PHOTOMETRIC DATA (cont'd)

L1EPH-24LS3-(W-H)/50K • 17,682.9lm

Polar candela distribution

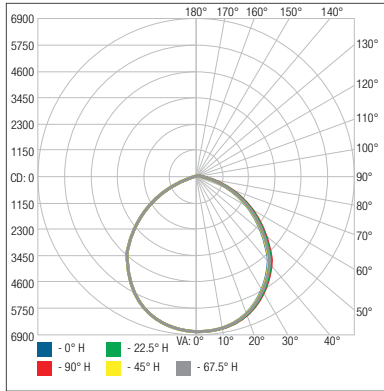

Zonal lumen summary

| Zone | Lumens | % Fixture |
|--------|----------|-----------|
| 0-30 | 5291.4 | 29.9% |
| 0-40 | 8624.1 | 48.8% |
| 0-60 | 14,669.5 | 83% |
| 60-90 | 3013.4 | 17% |
| 70-100 | 1160.4 | 6.6% |
| 90-120 | 0 | 0% |
| 0-90 | 17,682.9 | 100% |
| 90-180 | 0 | 0% |
| 0-180 | 17,682.9 | 100% |

Illuminance at a distance

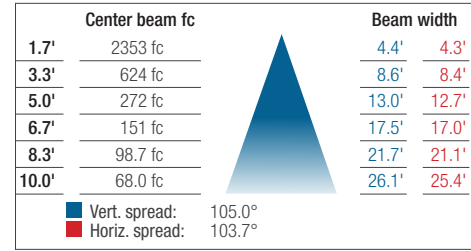

L1EPH-48LS1A-(W-H)/40K • 23,330.8lm

Polar candela distribution

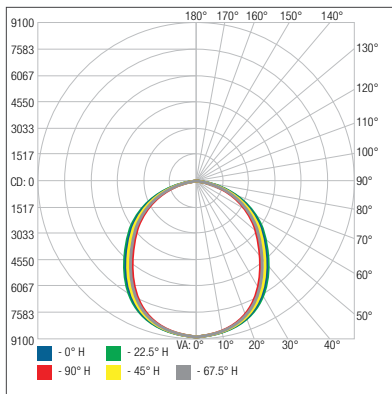

Zonal lumen summary

| Zone | Lumens | % Fixture |
|--------|----------|-----------|
| 0-30 | 6848.8 | 29.4% |
| 0-40 | 11,081.9 | 47.5% |
| 0-60 | 18,958.7 | 81.3% |
| 60-90 | 4367.6 | 18.7% |
| 70-100 | 1746.4 | 7.5% |
| 90-120 | 4.5 | 0% |
| 0-90 | 23,326.3 | 100% |
| 90-180 | 4.5 | 0% |
| 0-180 | 23,330.8 | 100% |

Illuminance at a distance

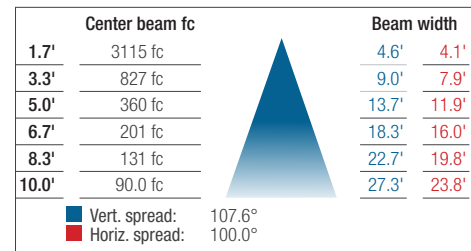

L1EPH-48LS1A-(W-H)/50K • 23,192.7lm

Polar candela distribution

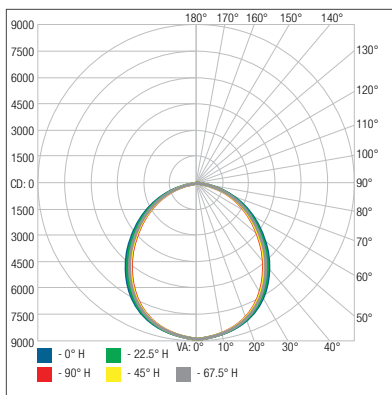

Zonal lumen summary

| Zone | Lumens | % Fixture |
|--------|----------|-----------|
| 0-30 | 6936.1 | 29.9% |
| 0-40 | 11,282.9 | 48.6% |
| 0-60 | 19,157.9 | 82.6% |
| 60-90 | 3954.5 | 17.1% |
| 70-100 | 1516.7 | 6.5% |
| 90-120 | 22.2 | 0.1% |
| 0-90 | 23,112.5 | 99.7% |
| 90-180 | 80.3 | 0.3% |
| 0-180 | 23,192.7 | 100% |

Illuminance at a distance

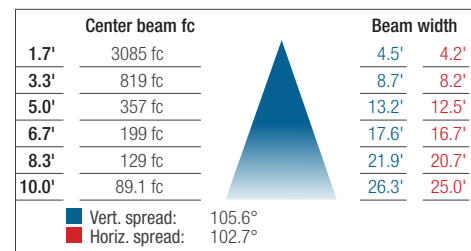

PHOTOMETRIC DATA (cont'd)

L1EPH-48LS2-(W-H)/40K • 37,732.6lm

Polar candela distribution

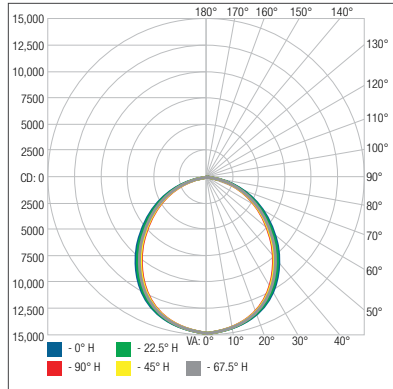

Zonal lumen summary

| Zone | Lumens | % Fixture |
|--------|----------|-----------|
| 0-30 | 11,400.0 | 30.2% |
| 0-40 | 18,359.5 | 48.7% |
| 0-60 | 30,915.8 | 81.9% |
| 60-90 | 6786 | 18% |
| 70-100 | 2751.9 | 7.3% |
| 90-120 | 13.6 | 0% |
| 0-90 | 37,701.8 | 99.9% |
| 90-180 | 30.7 | 0.1% |
| 0-180 | 37,732.6 | 100% |

Illuminance at a distance

| Center beam fc | Beam width |
|----------------|------------|
| 4.0' | 935 fc |
| 8.0' | 234 fc |
| 12.0' | 104 fc |
| 16.0' | 58.4 fc |
| 20.0' | 37.4 fc |
| 24.0' | 26.0 fc |

| Beam width | Beam width |
|------------|------------|
| 10.3' | 9.5' |
| 20.5' | 19.0' |
| 30.8' | 28.6' |
| 41.1' | 38.1' |
| 51.4' | 47.6' |
| 61.6' | 57.1' |

■ Vert. spread: 104.2°
■ Horiz. spread: 99.9°

L1EPH-48LS2A-(W-H)/50K • 33,522.3lm

Polar candela distribution

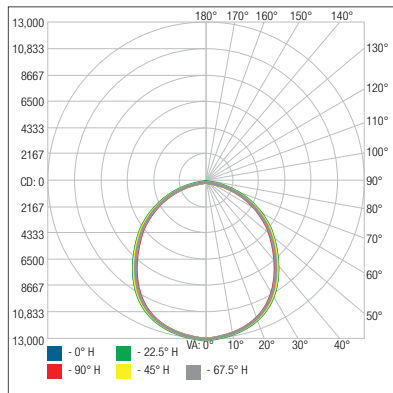

Zonal lumen summary

| Zone | Lumens | % Fixture |
|--------|----------|-----------|
| 0-30 | 9978.4 | 29.8% |
| 0-40 | 16,190.6 | 48.3% |
| 0-60 | 27,552.5 | 82.2% |
| 60-90 | 5969.8 | 17.8% |
| 70-100 | 2333.6 | 7% |
| 90-120 | 0 | 0% |
| 0-90 | 33,522.3 | 100% |
| 90-180 | 0 | 0% |
| 0-180 | 33,522.3 | 100% |

Illuminance at a distance

| Center beam fc | Beam width |
|----------------|------------|
| 1.7' | 4468 fc |
| 3.3' | 1186 fc |
| 5.0' | 516 fc |
| 6.7' | 288 fc |
| 8.3' | 187 fc |
| 10.0' | 129 fc |

| Beam width | Beam width |
|------------|------------|
| 4.5' | 4.3' |
| 8.7' | 8.3' |
| 10.1' | 12.5' |
| 17.6' | 16.8' |
| 21.8' | 20.8' |
| 26.2' | 25.0' |

■ Vert. spread: 105.3°
■ Horiz. spread: 102.8°

All products are subject to change or may be discontinued any time without notice.